

The information contained herein is proprietary and confidential to DECA AVIATION ENGINEERING LIMITED, both in content and format of presentation, and shall not be copied, duplicated, disclosed nor used, in whole nor in part, by any person, persons or organizations, without the expressed written consent of DECA AVIATION ENGINEERING LIMITED.

RECORD OF REVISIONS			
REV	DATE (DD/MM/YY)	DESCRIPTION OF CHANGES	DWN APPD
A	12/12/12	INITIAL ISSUE	CES <i>TR</i>

## GENERAL NOTES:

- PERFORM ALL WORK IN ACCORDANCE WITH STANDARD PRACTICES OF AS350 AMM, AND/OR AC43.13-1B/2B:
  - METAL WORK \* AC43.13-1B, CHAPTER 4 & 6,
  - AIRCRAFT HARDWARE \* AC43.13-1B, CHAPTER 7,
  - STRUCTURAL DATA \* AC43.13-2A, CHAPTER 1.
- EQUIVALENT FASTENERS MAY BE USED IN LIEU OF THOSE SPECIFIED. FASTENER LENGTH TO BE DETERMINED ON INSTALL.
- DEBURR, BRUSH ALODINE (AS PER MIL-C-5541), EPOXY PRIME (AS PER MIL-P-23377) ALL MODIFIED OR NEWLY FABRICATED BARE METAL PARTS.

**13** DEBURR HOLE AND REMOVE DEBRIS AND LOOSE MATERIAL FROM CAVITY AND SURFACE OF COMPOSITE PANEL. FILL UNDERCUT WITH EPOCAST 87269-A/B (OR EQUIVALENT) TO MATCH THE HOLE EDGE IN THE FACINGS, SAND SMOOTH AND FLUSH WHEN CURED.

**14** ANTENNA INST. I.A.W MANUFACTURERS INSTRUCTIONS. ENSURE REQUIRED ELECTRICAL BONDING BETWEEN DOUBLER AND AIRCRAFT GROUND USING ELECTRICAL STRAPS.

**15** FOR SINGLE ANTENNA RHS INSTL IS SHOWN. OPPOSITE LHS INSTALLATION IS ACCEPTABLE.

**7** LOCATE ON INSTALL ON CENTER PEDESTAL DZUS RAIL. INSTALL I.A.W. MANUFACTURERS INSTRUCTIONS.

**8** SIZE/TRIM PARTS TO SUIT INSTALL.

**9** RESERVED

**10** RESERVED

**11** ENSURE ANTENNA IS 6 INCHES CLEAR OF ANY EXISTING STRUCTURES IE. LIGHTS, LANDING GEAR, JACKING MOUNTS OPENINGS, OR OTHER EXISTING ANTENNAS. SPACE ANTENNA WITH RESPECT TO ITS CONNECTOR.

**12** MATCH FOOTPRINT OF ANTENNA AND MOUNTING HOLES.



QTY	DASH	NO	DESCRIPTION	MATERIAL	SPEC	SIZE	ITEM			
1	1	OB1252-(-)-(-)	TDFM-136B TRANSCEIVER	(VHF FM COMM)	TECHNISONIC	3.5 LBS	302			
2	1	CL292-3	FM EXT BAND BENT WHIP ANTENNA		COMANT	0.5 LBS	301			
6	3	MS21058L3	NUTPLATE, ZLUG, SELF-LOCKING			#10-32	205			
6	3	P101D31-(-)	PLUG INSERT				204			
6	3	S101D31-(-)	SLEEVE INSERT				203			
12	6	MS20428AD3	RIVET, SOLID, 100DEG CSK				202			
6	3	MS27039-(-)	SCREW, MACHINE, PAN HEAD			#10-32	201			
2	1	-101	CL292 INTERNAL DOUBLER	AL ALY 2024-T3	QQ-A-250/5	0.050" THK	101			
		-003	DUAL TDFM 136B INSTALLATION	136B CONFIGURATION			3			
		-001	SINGLE TDFM 136B INSTALLATION	136B CONFIGURATION			1			
		-003	NUMBER	SHT	ZONE	DESCRIPTION	MATERIAL	SPEC	SIZE	ITEM

LIST OF MATERIAL  
ODD DASH NUMBER IS SHOWN. THE NEXT HIGHER CONSECUTIVE EVEN DASH NUMBER IS OPPOSITE.

**15**

REVISION	COMPUTER GENERATED DOCUMENT DO NOT REVISE MANUALLY DO NOT SCALE DRAWING	DRAWN C. SUTTON	DATE 12-12-12	7050 TELFORD WAY, UNIT 200 MISSISSAUGA, ONTARIO CANADA L5S 1V7 TEL (905) 405-1371 FAX (905) 405-1373
REVISION RECORD		CHECKED <i>T. Muller</i>	DATE 2/1/13	
DWN/DATE	AS350	UNLESS OTHERWISE SPECIFIED, ALL LINEAR DIMENSIONS ARE IN INCHES.		TECHNISONIC ANTENNA INSTALLATION - AS350
CHECK/DATE	APPLICATION	TOLERANCES: LINEAR: X.XX ±0.03 X.XXX ±0.010 ANGULAR: X.X ±0°30'		
		MACHINED SURFACES: 125 ✓	SIZE B	DWG NUMBER: 5004214
			SCALE: NTS	NCAGE: L6518
			SHEET 1	OF 6

DWG NO 5004214 REV A

The information contained herein is proprietary and confidential to DECA AVIATION ENGINEERING LIMITED, both in content and format of presentation, and shall not be copied, duplicated, disclosed nor used, in whole nor in part, by any person, persons or organizations, without the expressed written consent of DECA AVIATION ENGINEERING LIMITED.

# WEIGHT & BALANCE

NOTE: RECALCULATE MOMENT WITH ANY DEVIATION TO THE ITEM LOCATIONS

FOR AS350 (ALL ANTENNA INSTALLED)				
ITEM	DESCRIPTION	WEIGHT (LBS)	ARM (IN)	MOMENT (LBSxIN)
301	CL 292-3	0.5	88.52	44.26
302	TRANSCEIVER	3.5	31.40	109.940

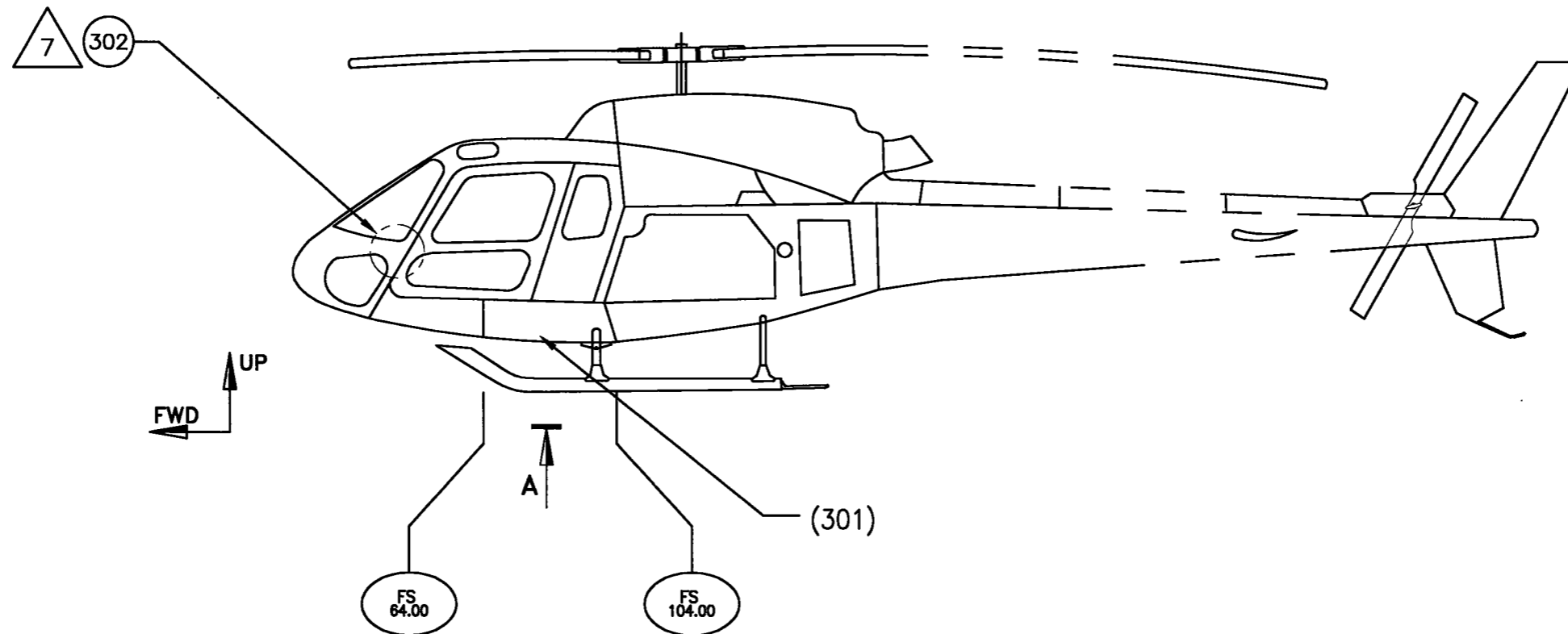

-001 SINGLE TDFM 136B INSTALLATION  
GENERAL LAYOUT

**DECA** 7050 TELFORD WAY, UNIT 200  
MISSISSAUGA, ONTARIO  
CANADA L5S 1V7  
AVIATION ENGINEERING LIMITED TEL (905) 405-1371 FAX (905) 405-1373

TECHNISONIC ANTENNA  
INSTALLATION - AS350

SIZE B	DWG NUMBER: 5004214	REV A
SCALE: NTS	NCAGE: L6518	SHEET 2 OF 6

DWG NO 5004214  
SH 2  
REV A

The information contained herein is proprietary and confidential to DECA AVIATION ENGINEERING LIMITED, both in content and format of presentation, and shall not be copied, duplicated, disclosed nor used, in whole nor in part, by any person, persons or organizations, without the expressed written consent of DECA AVIATION ENGINEERING LIMITED.

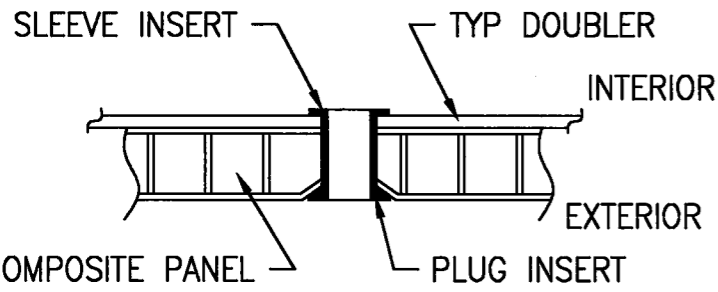
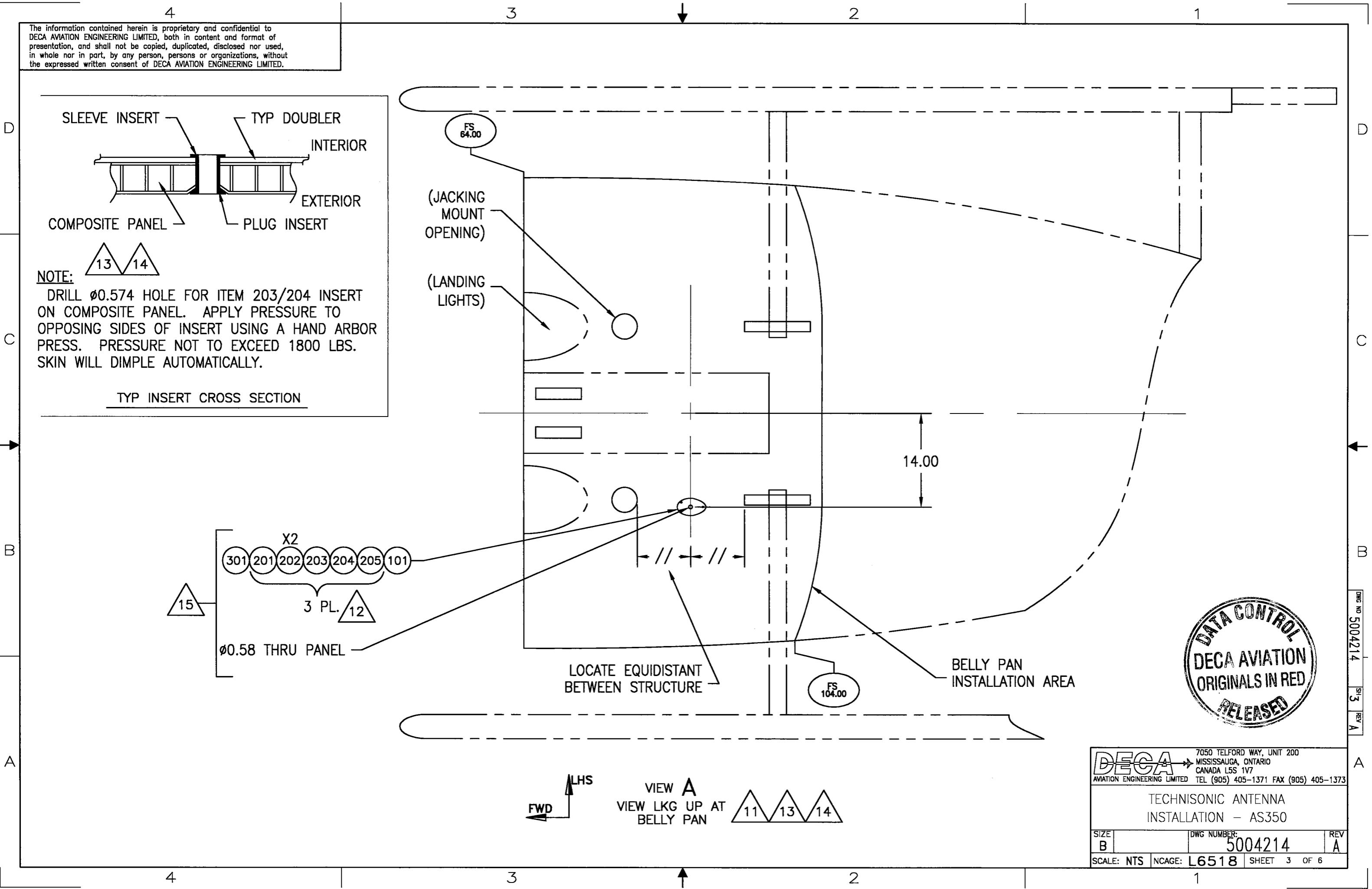

**NOTE:** DRILL  $\phi 0.574$  HOLE FOR ITEM 203/204 INSERT ON COMPOSITE PANEL. APPLY PRESSURE TO OPPOSING SIDES OF INSERT USING A HAND ARBOR PRESS. PRESSURE NOT TO EXCEED 1800 LBS. SKIN WILL DIMPLE AUTOMATICALLY.

TYP INSERT CROSS SECTION

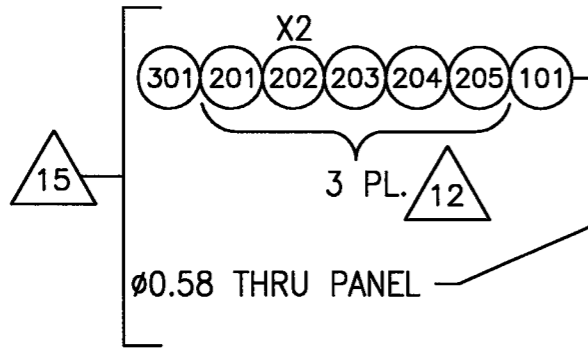

$\phi 0.58$  THRU PANEL



**DECA** 7050 TELFORD WAY, UNIT 200  
 MISSISSAUGA, ONTARIO  
 CANADA L5S 1V7  
 AVIATION ENGINEERING LIMITED TEL (905) 405-1371 FAX (905) 405-1373

TECHNISONIC ANTENNA  
 INSTALLATION - AS350

SIZE B	DWG NUMBER: 5004214	REV A
SCALE: NTS	NCAGE: L6518	SHEET 3 OF 6

VIEW A  
 VIEW LKG UP AT  
 BELLY PAN

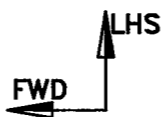

DWG NO 5004214 SH 3 REV A

The information contained herein is proprietary and confidential to DECA AVIATION ENGINEERING LIMITED, both in content and format of presentation, and shall not be copied, duplicated, disclosed nor used, in whole nor in part, by any person, persons or organizations, without the expressed written consent of DECA AVIATION ENGINEERING LIMITED.

# WEIGHT & BALANCE

NOTE: RECALCULATE MOMENT WITH ANY DEVIATION TO THE ITEM LOCATIONS

FOR AS350 (ALL ANTENNA INSTALLED)				
ITEM	DESCRIPTION	WEIGHT (LBS)	ARM (IN)	MOMENT (LBSxIN)
301	CL 292-3	1.0	88.52	88.52
302	TRANSCEIVER	3.5	31.40	109.940

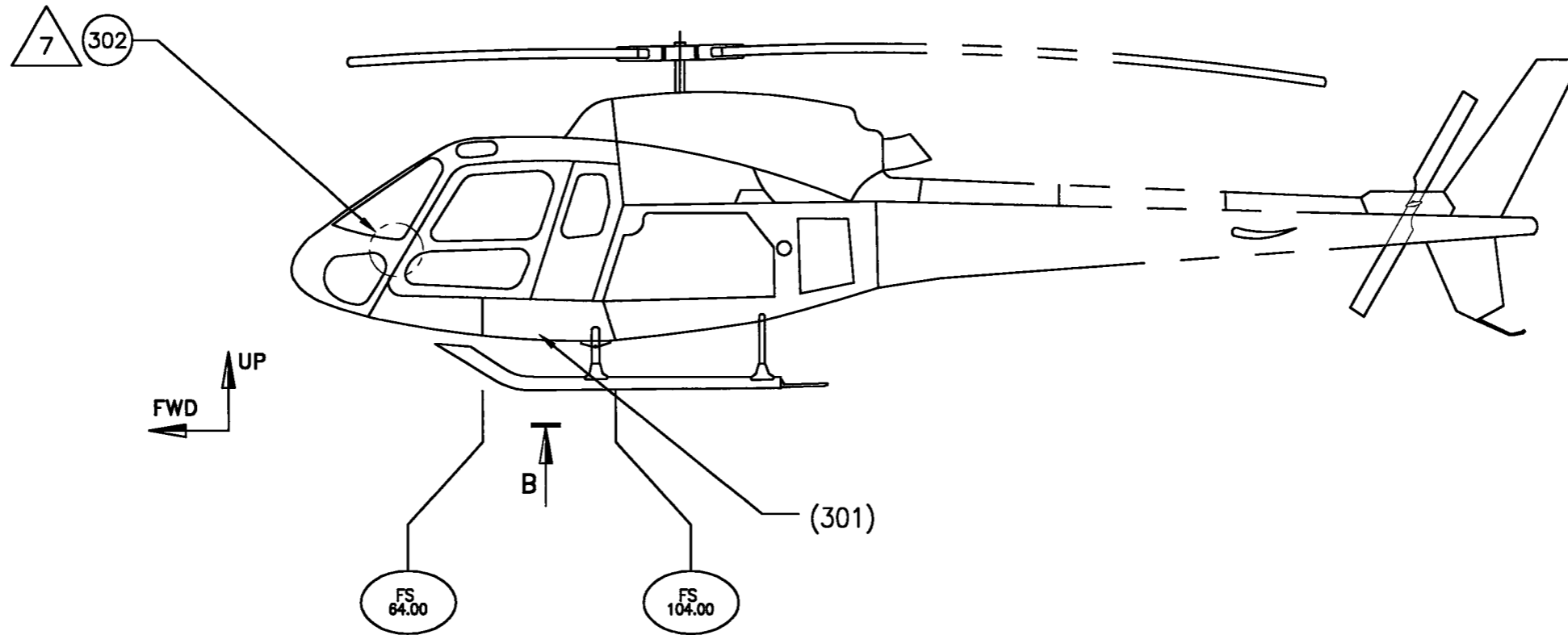

## -003 DUAL TDFM 136B INSTALLATION

GENERAL LAYOUT

**DECA** 7050 TELFORD WAY, UNIT 200  
 MISSISSAUGA, ONTARIO  
 CANADA L5S 1V7  
 AVIATION ENGINEERING LIMITED TEL (905) 405-1371 FAX (905) 405-1373

TECHNISONIC ANTENNA  
 INSTALLATION - AS350

SIZE B	DWG NUMBER: 5004214	REV A
SCALE: NTS	NCAGE: L6518	SHEET 4 OF 6

DWG NO 5004214 SH 4 REV A

The information contained herein is proprietary and confidential to DECA AVIATION ENGINEERING LIMITED, both in content and format of presentation, and shall not be copied, duplicated, disclosed nor used, in whole nor in part, by any person, persons or organizations, without the expressed written consent of DECA AVIATION ENGINEERING LIMITED.

D  
C  
B  
A

LOCATE EQUIDISTANT BETWEEN STRUCTURE

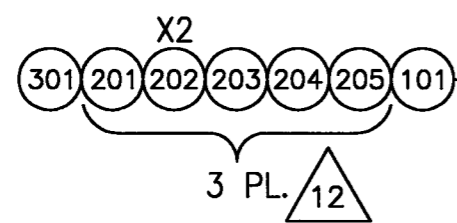
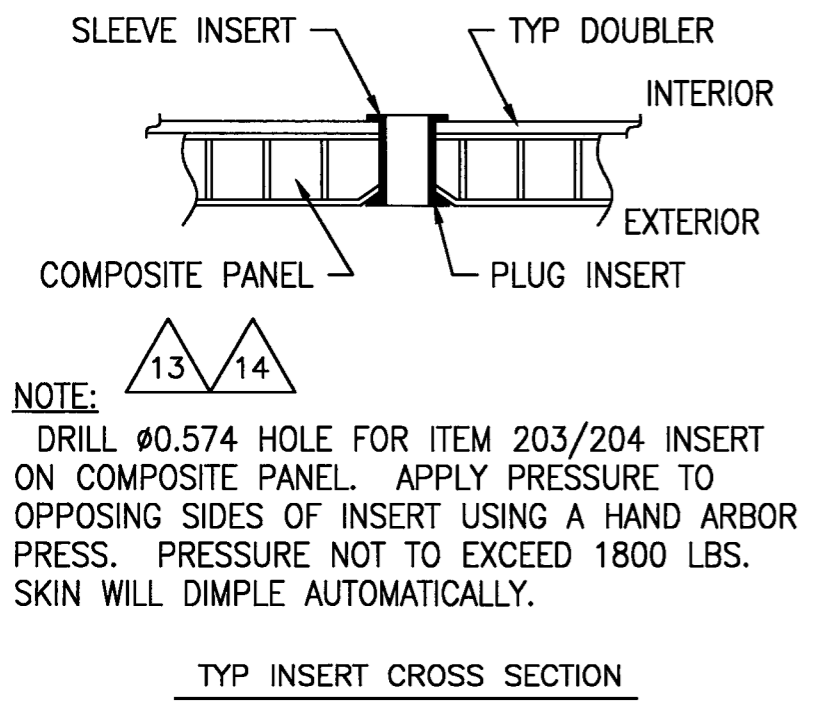

$\phi 0.58$  THRU PANEL

(JACKING MOUNT OPENING)

(LANDING LIGHTS)

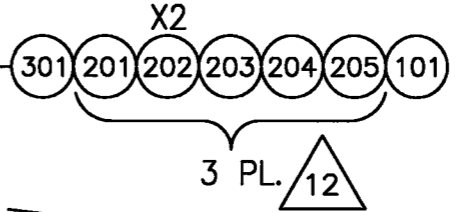

LOCATE EQUIDISTANT BETWEEN STRUCTURE

BELLY PAN INSTALLATION AREA

FS 104.00

FS 64.00

14.00

14.00

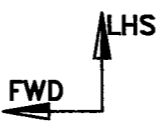

VIEW B  
VIEW LKG UP AT  
BELLY PAN



DECA 7050 TELFORD WAY, UNIT 200 MISSISSAUGA, ONTARIO CANADA L5S 1V7  
AVIATION ENGINEERING LIMITED TEL (905) 405-1371 FAX (905) 405-1373

TECHNISONIC ANTENNA  
INSTALLATION - AS350

SIZE B	DWG NUMBER 5004214	REV A
SCALE: NTS	NCAGE: L6518	SHEET 5 OF 6

A

4

3

2

1

DWG NO 5004214 SH 5 REV A

The information contained herein is proprietary and confidential to DECA AVIATION ENGINEERING LIMITED, both in content and format of presentation, and shall not be copied, duplicated, disclosed nor used, in whole nor in part, by any person, persons or organizations, without the expressed written consent of DECA AVIATION ENGINEERING LIMITED.

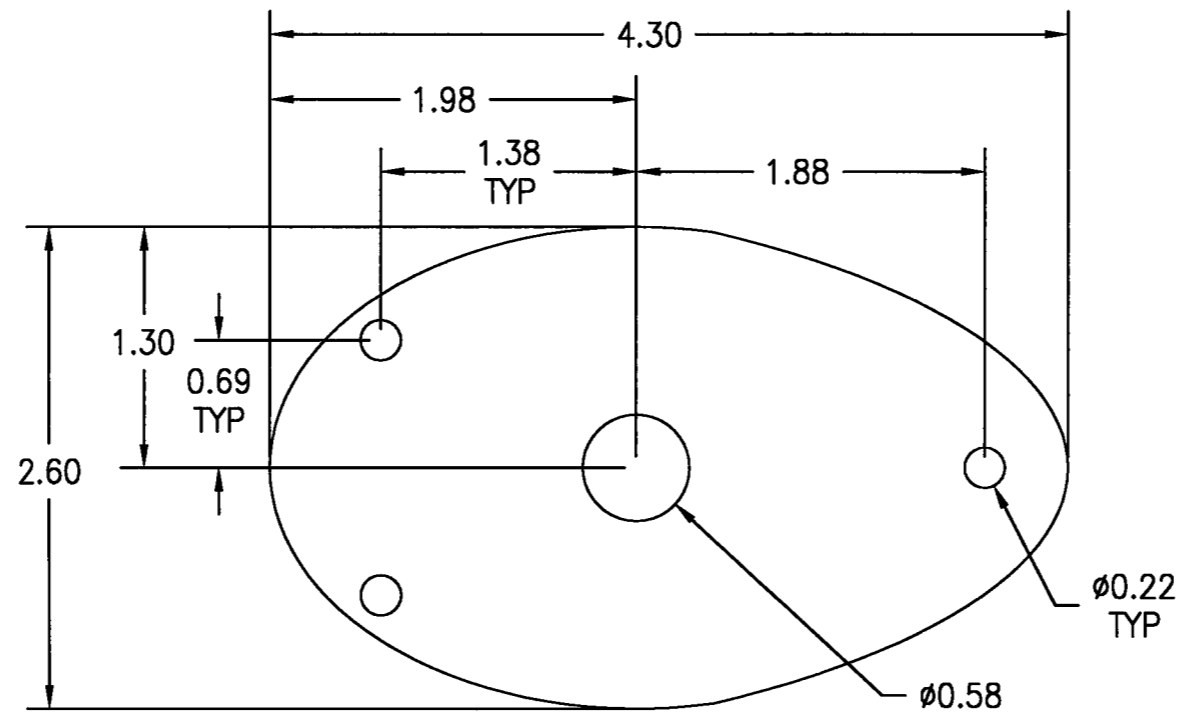

-101 CL292 INTERNAL DOUBLER 



**DECA** 7050 TELFORD WAY, UNIT 200  
 MISSISSAUGA, ONTARIO  
 CANADA L5S 1V7  
 AVIATION ENGINEERING LIMITED TEL (905) 405-1371 FAX (905) 405-1373

TECHNISONIC ANTENNA  
 INSTALLATION - AS350

SIZE: B	DWG NUMBER: 5004214	REV: A
SCALE: NTS	NCAGE: L6518	SHEET 6 OF 6

DWG NO 5004214  
 6  
 REV A

A